



7 Whitestripes Crescent | Bridge of Don | AB22 8WB

One Bedroom Terraced Bungalow

Offers Over £115,000

We offer for sale this one bedroom terraced bungalow with additional box room in the ever popular area of Bridge of Don. The property offers generously proportioned accommodation throughout and although would require some upgrading and redecoration offers huge potential for a purchaser to provide their own impression on the property.

There is an entrance porch leading to the lounge, a spacious room with an outlook to the front of the property. The room is capable of hosting a wide range of furniture and leads to the hallway granting access to the remaining accommodation. The kitchen is situated to the rear and has been fitted with a range of base and wall units with a lovely outlook to the rear garden. There is a double bedroom allowing space for various bedroom furniture and an additional box room which could provide ideal space for a study or various other requirements depending on the purchasers preference. There is a shower room to the rear offering a white suite comprising a w.c., hand wash basin and enclosed shower cubicle.

To the rear the property offers a fully enclosed and generous rear garden laid to lawn.

ACCOMMODATION

Lounge

11'2" x 14'1" (3.4m x 4.29m) approx.

Kitchen

11'3" x 9'4" (3.43m x 2.85m) approx.

Double Bedroom

10'5" x 10'8" (3.18m x 3.25m) approx.

Box Room

7'4" x 6'4" (2.24m x 1.93m) approx.

Shower Room

6'4" x 7'2" (1.93m x 2.18m) approx.

Gas Central Heating

Double Glazing

Rear Garden

Private Parking

EPC Band - D



Lounge



Lounge



Kitchen



Kitchen



Double Bedroom



Boxroom



Shower Room



Rear

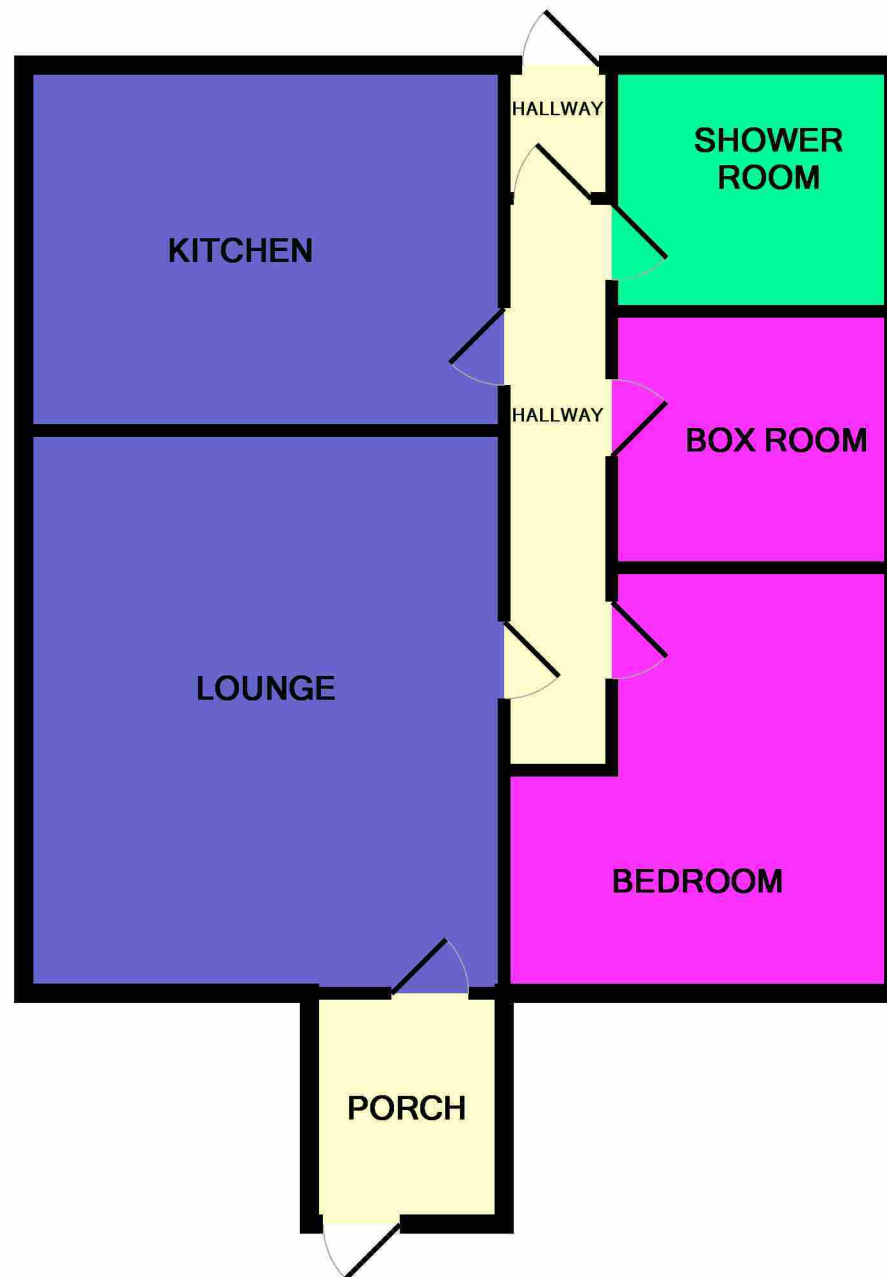

Floorplan

Property location

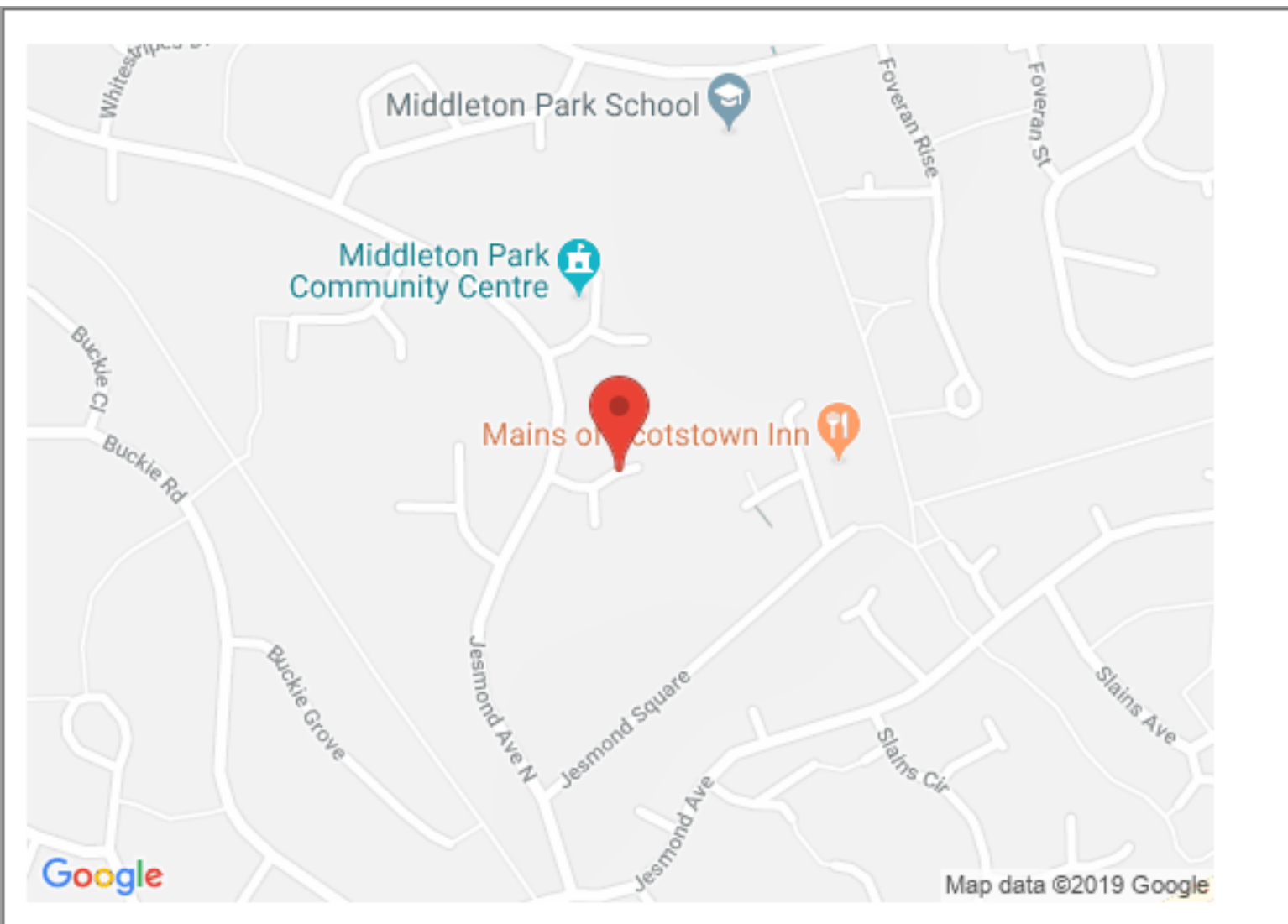

Directions: From Aberdeen travel north on North Anderson Drive until you reach the Haudagain roundabout. Proceed straight on and down the hill to the roundabout, turn right across the bridge and proceed to the next roundabout. Go straight on, up the hill (Tesco on your right). Proceed to the next roundabout and turn left into Whitestripes Avenue then first right into Valentine Road and fourth left into Jesmond Avenue North. Whitestripes Crescent is on your right.

Location: Bridge of Don is a very popular residential area lying to the north of the city. There is an excellent choice of primary schools and secondary education is provided at Oldmachar and Bridge of Don Academies. There are ample shopping, sports and recreational facilities. There are also numerous clubs and associations. Bridge of Don is well served by public transport and the city centre is within easy driving distance. The Industrial Estates of both Bridge of Don and Dyce, together with the Airport are close at hand

Ledingham Chalmers
Johnstone House, 52-54 Rose Street
Aberdeen AB10 1HA
Tel: 01224 632500 • Fax: 01224 408444
Email: property@ledinghamchalmers.com
Web: www.ledinghamchalmers.com

Whilst every effort has been made to ensure the accuracy of the information contained in this Schedule, including the floor plan (if applicable) please note that all measurements have been taken with a sonic tape measure and as a result are only close approximations; the measurement of doors, rooms and windows and all other items are approximate and no responsibility is taken for any error, omission or mis-statement. Any plans are for illustrative purposes only and should be used as such by prospective purchasers.